

# Self-contained air-conditioners

BlueCool S-Series 115 V



Our self-contained air-conditioning units are the perfect solution for vessels with up to three cabins. High-efficiency compressors guarantee extra-low power consumption. These air-conditioners are very compact and thus also very easy to retrofit.

The complete range offers high performance although the units are quiet and very compact.

The S-Series offer a unique feature with the BlueCool Expert Tool that is connected via a single USB cable to a PC. On site servicing and remote assistance are now a child's play.

## Advantages at a glance:

- Very high efficiency, using R410a refrigerant
- Continuous operation even under tropical conditions
- USB diagnosis for easy servicing and parameter setting
- Quiet operation
- Robust design
- Soft start devices available as an option
- Vibration absorber kits available as an option

## BlueCool Self contained systems

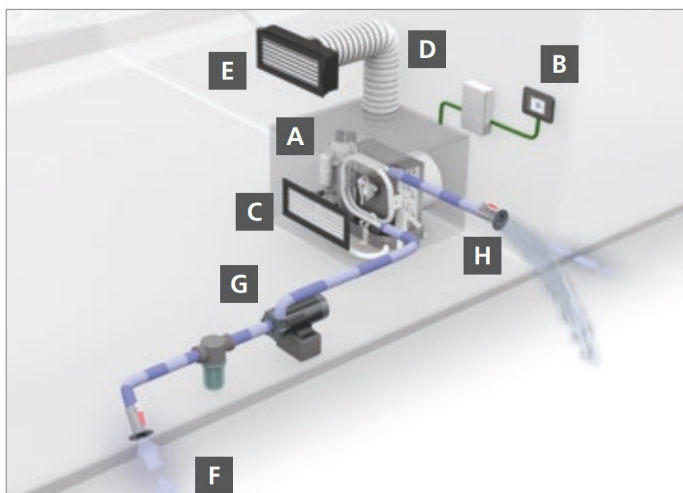

## Installation example:

- A** Air-conditioning unit
- B** Control box with MyTouch display
- C** Supply air grille
- D** Air ducting
- E** Supply air grille
- F** Sea water inlet
- G** Sea water pump
- H** Overboard discharge



## Technical Specifications

Model	S6	S8	S10	S13	S16
Cooling capacity (BTU / h)	6,000	8,000	10,000	13,000	16,000
Cooling capacity (kW)	1.8	2.4	2.9	3.8	4.7
Heating via reverse cycle integrated	yes	yes	yes	yes	yes
Voltage (V)	115 (-15% / +10%)	115 (-15% / +10%)	115 (-15% / +10%)	115 (-15% / +10%)	115 (-15% / +10%)
Frequency (Hz)	60	60	60	60	60
Current draw running (60Hz) (A)	3.6 – 5.5	4.5 – 6.1	5.6 – 7.9	7.6 – 11.0	8.0 – 15.7
Current draw Start max. peak (60Hz) (A)	39	54	55	70	89
Air flow (free blowing) (60Hz) (m <sup>3</sup> / h, cfm)	275 / 162	275 / 162	350 / 206	430 / 253	650 / 382
Sea water connection (mm / inch)	19 3 / 4	19 3 / 4	19 3 / 4	19 3 / 4	19 3 / 4
Minimum sea water flow at 60Hz (l / min.)	6	8	10	12	14
Dimensions unit (L x D x H) (mm / inch)	405 x 320 x 300 15.9 x 12.6 x 11.8	405 x 320 x 305 15.9 x 12.6 x 12.0	480 x 335 x 315 18.9 x 13.2 x 12.4	510 x 345 x 325 20.1 x 13.6 x 12.8	550 x 340 x 370 21.7 x 13.4 x 14.6
Dimension electronic box (L x D x H) (mm / inch)	310 x 214 x 83 12.2 x 8.4 x 3.3	310 x 214 x 83 12.2 x 8.4 x 3.3	310 x 214 x 83 12.2 x 8.4 x 3.3	310 x 214 x 83 12.2 x 8.4 x 3.3	310 x 214 x 83 12.2 x 8.4 x 3.3
Ø Blower connection (mm / inch)	100 / 4	100 / 4	100 / 4	125 / 5	125 / 5
Weight core unit (kg)	18	18	20	25	29
Weight electronic box (kg)	2	2	2	2	2



### BlueCool MyTouch Display

The BlueCool MyTouch display is the new standard display for all BlueCool A/C Series:

- Full color, high resolution, interactive 2,4" touch screen
- Multiple customization options available (design, colors, language, photos, etc.)
- Protected: full access to system configuration parameters
- Compatible with Vimar Eikon, Eikon EVO, Plana, Bticino Axolute

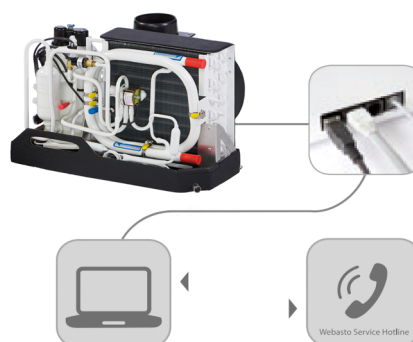

### BlueCool Expert Tool

BlueCool Expert Tool suitable for all BlueCool AC units:

- Plug and Play USB connection
- Easy parameter setting
- Real time monitor function
- Continuous data logging
- Manual activation of single components (pumps, compressors, 4 / 2 way valve etc.)
- Possible remote access via internet



Contact details

webasto.com